

# Welcome to Your Chromebook!

Let's login and find your class!



## Step 1 – Connect to Wi-Fi

When you open the lid to your charged Chromebook, it will prompt you to connect to Wi-Fi. **Find your home Wi-Fi** in the list and click it to connect. If a password is required, enter the password and click **Connect**.

Open the lid to your charged Chromebook and connect to your home Wi-Fi.

Enter Password & Click Connect

Look for your home Wi-Fi connection in the list and click on it to connect to the internet.

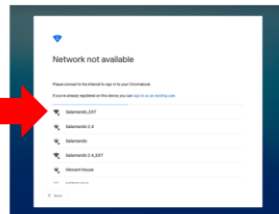

If your home Wi-Fi requires a password, type it in and click **Connect**.

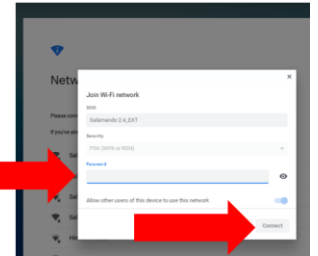

## Step 2 – Sign In to the Chromebook

You will see several screens as you begin the process, click **Next** to sign in, then, select **Login with Active Directory**.

Click Next to Sign In

Click Login with Active Directory

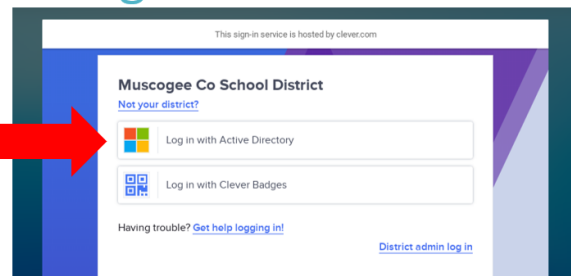
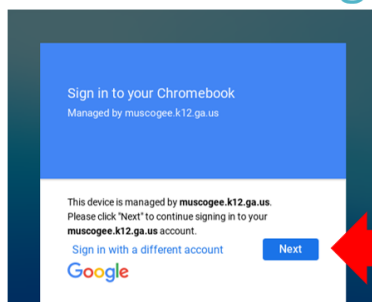

Enter your login information in the correct format and click to **Sign In**. Students will use their GTID followed by @mcsdgas.com to login. Login Example: **123456789@mcsdgas.com** Passwords are your normal MCSD computer password.

## Type in Your Login and Password

Students will use their GTID followed by @mcsdgas.com to login.

Login Example:

**123456789@mcsdgas.com**

Default passwords for grades 3-12 are in the format of **mcmmddy**, mc (for Muscogee County), then the two digit month, day and year of birth.

Default for K-2 is **initpass**.

Example default password for birthday 1/1/06:

**mc010106**

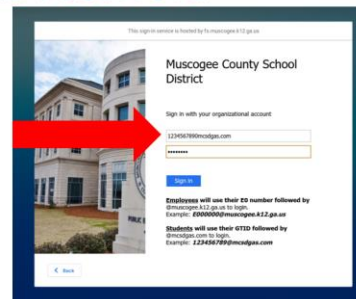

**Special Note:** Default passwords for grades 3-12 are in the format of **mcmmddy**, mc (for Muscogee County), then the two digit month, day and year of birth. Example default password for birthday 1/1/06: **mc010106**

Default password for K-2 students is **initpass**

When the login process is complete, you may receive an “All Set” screen, click Get Started to begin and wait for the Clever dashboard to load. Please Note: Clever may take several minutes to load the first time you login.

After a few seconds you are All Set!

Click **Get Started** to begin!

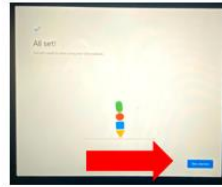

### Step 3 – Login to Canvas to Find Your Classes

Scroll down on the Clever dashboard to find and click the **Canvas** icon. If you have never logged in to Canvas before, you may be prompted to enter your password and click Save. **Wait** for Canvas to login automatically. **Do not attempt to type anything in or press any buttons** as you see a couple of Canvas login screens pop up. If you happen to get an error message, go back to the Clever page, click Canvas again and **wait** for it to load and log you in.

#### Access Canvas from Clever

After the Clever dashboard loads, scroll down to find and click the **Canvas** icon.



If you have never logged in to **Canvas** before, you may be prompted to enter your password again and click Save.



#### Wait for Canvas to Load and Login

Pause for a few moments as Canvas logs you in to the program.

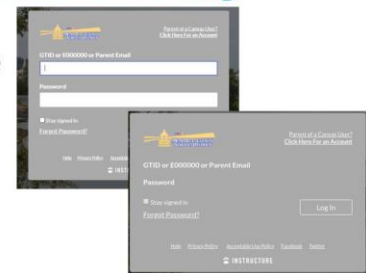

As you see these screens, do NOT attempt to type anything in, or press any buttons, **just wait**.

### Step 4 – Find Your Class on the Canvas Dashboard

From the **Canvas Dashboard**, locate your first class of the day and click the class card to begin. Your dashboard may be in List View or Card View.

#### You're in the Canvas Dashboard!

Your Canvas Dashboard may look like this photo in the default **List View**.

Look for your first class to begin.

If your Canvas Dashboard does not look like this, it may be in Card View (see next slide).

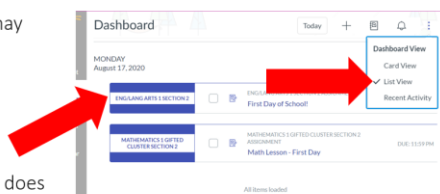

#### Canvas Dashboard in Card View

Your Canvas Dashboard may appear in **Card View**.

You will find your class and click on the course card to begin.

Special Note: Notice the helpful **To Do** list on the right hand side.

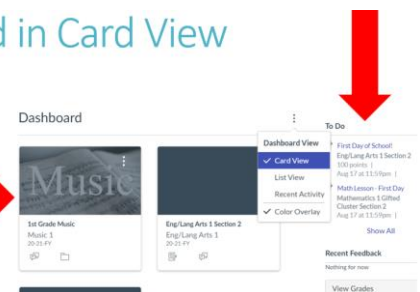

From this point you will follow any special directives assigned to you by your school. Have a great year!

### TECHNOLOGY ASSISTANCE:

Parents and students can access the Technology Call Center at 706-748-2271, Monday - Friday.