

Logging into Clever from Home Instructions

- Step 1: Power on the Chromebook and connect to your home Wifi

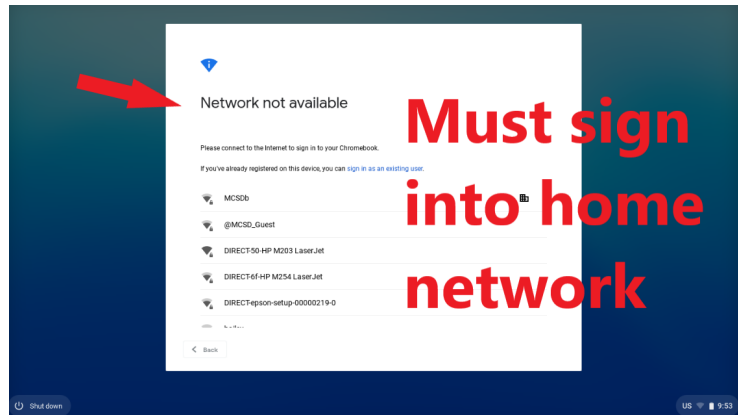

- Step 2: Click next to log into your Chromebook

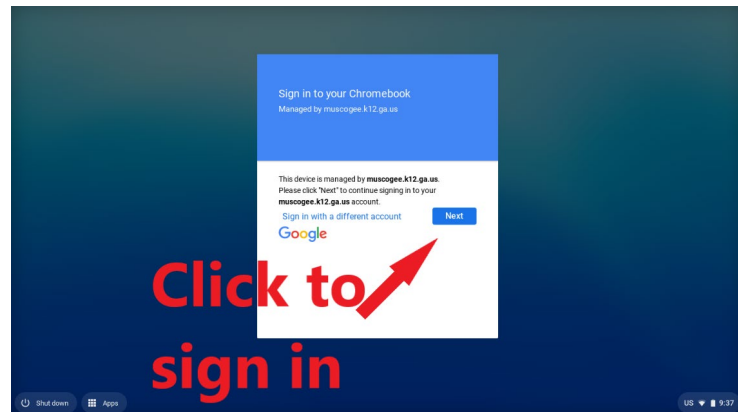

- Step 3: Use log in with active directory

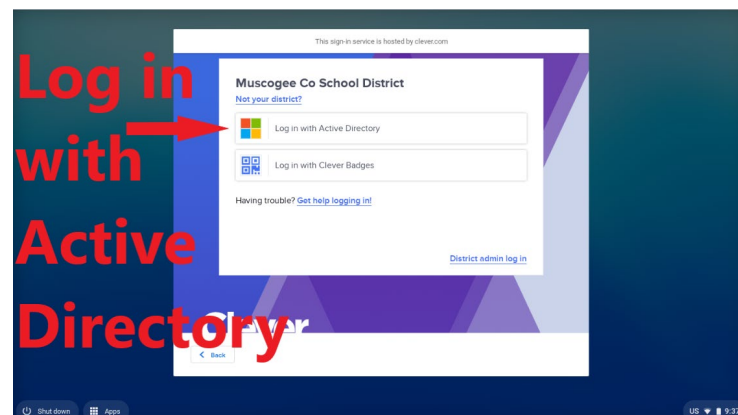

Logging into Clever from Home Instructions

- Step 4: Continue login process with GTID and your password

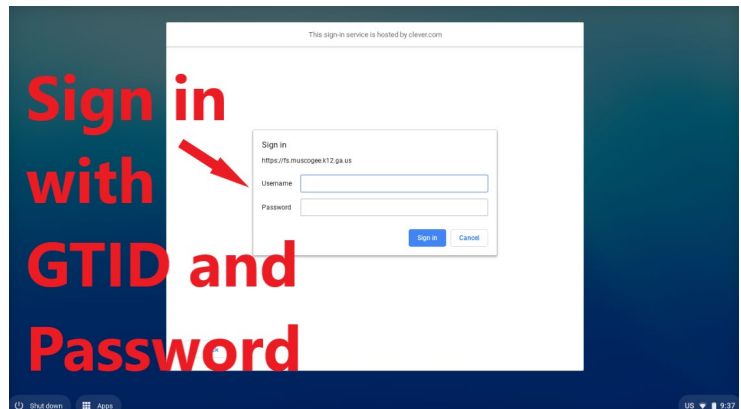

- Step 5: Navigate to the Muscogee county webpage

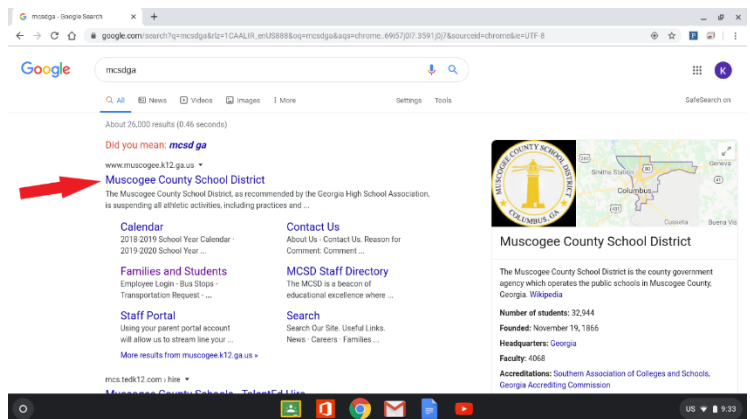

- Step 6: Proceed to the Families & Student page

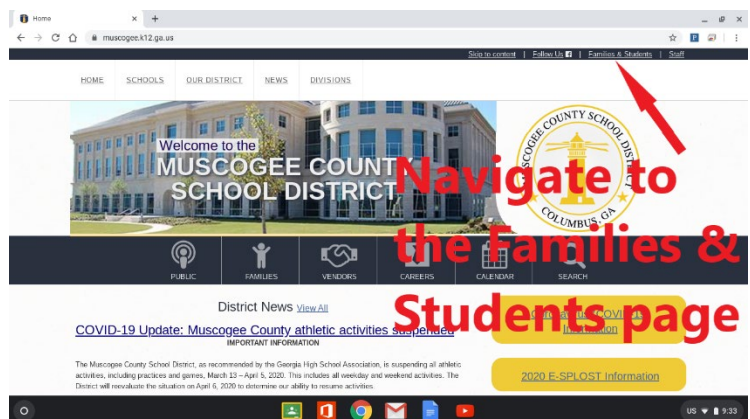

Logging into Clever from Home Instructions

- **Step 7: Use the link for the Clever login**

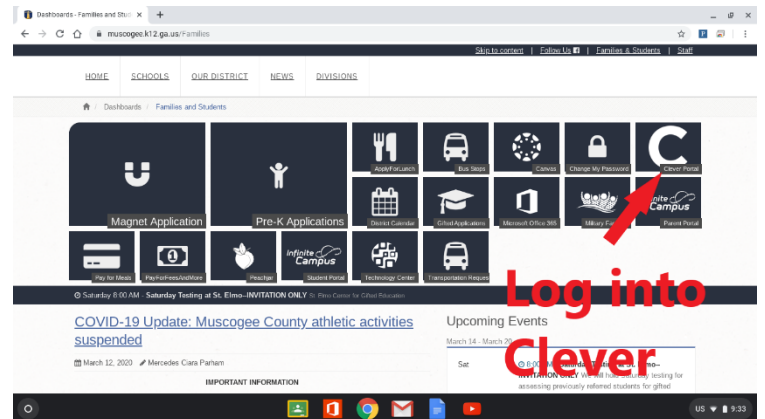

- **Step 8: You should automatically be logged in and be able to navigate to any website needed for instructional purposes**

